



70 SERIES

71 SERIES (Top Rod Only)

Concealed Vertical Rod Device - Wide Stile Wood Doors

The 70 and 71 Series **concealed vertical rod exit device** is super-heavy-duty **panic** and **fire exit hardware** for use on all types of wooden double doors without a mullion. The patented mounting plate system ensures the easiest and most accurate installation of panic hardware available.

Note: For Top Rod Only -
Specify 71 Series



70 Series Shown -
(Top and Bottom Bolt)

ANSI 156.3 - 2008
Grade 1
Type 7

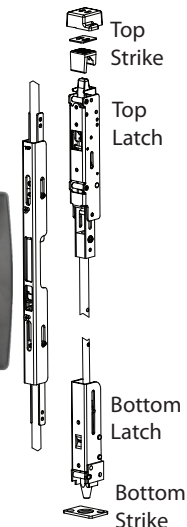

Benefits -

- Tough and durable design for years of trouble-free service in high-use, high-abuse environments
- Minimal door prep saves time and money
- Aesthetically pleasing options to meet various applications including:
 - 60/61 CVR Narrow Stile Alum. Door
 - 62/63 CVR Narrow Stile H.M. Door
 - 70/71 CVR Wide Stile Wood Door
 - 80/81 CVR Wide Stile H.M. Door
 - 82/83 CVR Wide Stile Alum. Door
- Fast and accurate installation
- Except for 03WSV, outside trims are easily changed or rekeyed without removing device from door

Features -

- 6-position multi-step action in top latch keeps top and bottom bolts retracted until door closes and provides more consistent re-latching and security to door
- Top strike fully adjustable both vertically and to accommodate a variety of varying weather strip thicknesses
- Top strike both secures the door and re-engages the latchbolts
- Patented deadlocking of top (70 and 71 Series) and bottom (70 Series) bolt assemblies
- Durable steel bottom drop bolt (70 Series)
- Rods are easily adjustable with rods installed in door
- Angled end-cap deflects damage away from device
- Handed - field reversible
- Field sizeable
- 1/8 turn dogging

Mechanical Options -

- F - 90 minutes without astragal up to 10 foot door
- HD - Hex Dogging (Std.)
- CD - Cylinder Dogging
- LD - Less Dogging
- SLR - Silencer
- 30 - Fits 30" Door Width - limited electrical options
- 36 - Fits 36" Door Widths (Std.)
- 48 - Fits 48" Door Widths
- EC1 - Ramped Endcap - Heavy duty (standard on 630, 606, 612, 613, 605, 611 & 629 finishes only)
- EC2 - Flush Endcap (standard on 628, 693 & 695 Finishes only)

Electrical Options -

- Exit Alarm (EA)
- Electric Dogging (ED)
- Electric Latch Retraction (ER)
- Delayed Egress Self-Contained (EE)
- Request to Exit (EX)
- Request to Exit for High Voltage (EXV)
- Electric Delayed Egress x Latch Retraction (EEExER)

Refer to Electrified Options section for more information

Where Trust is Built™
DETEx®
Life Safety and Security Door Hardware

Accessories -

- SSK - Security Torx Screw Kit

Technical Information -

- Door Types - Wood
- Door Stile - Fits minimum 5"
- Door Thickness - Fits standard 1-3/4" - 2 1/4" (for other door thicknesses contact factory)
NOTE: For secure installation, Detex recommends minimum 2" thick doors
- Fasteners - Wood screws supplied standard
- Rail is heavy ribbed aluminum extrusion

Finishes -

605 / US3	Polished Brass	628 / US28	Satin Aluminum	693 / SPBLK	Black, painted
606 / US4	Brushed Brass	629 / US32	Polished Stainless Steel	695 / SP313	Dark Bronze, painted
611 / US9	Polished Bronze				
612 / US10	Brushed Bronze	630 / US32D	Brushed Stainless Steel		
613 / US10B	Oil Rubbed Bronze				

Top Latch Installation - for 70 & 71 Series

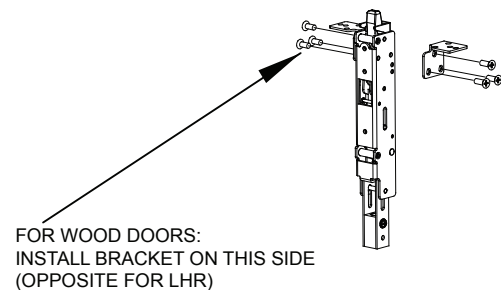

FOR **FIRE RATED** WOOD DOORS:
INSTALL BRACKETS ON BOTH SIDES

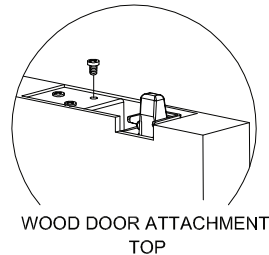

Bottom Latch Installation - for 70 Series Only

Note: Bottom bracket may slide up on rod during assembly. It may be necessary to pull it towards bottom edge of door with a simple wire hook.

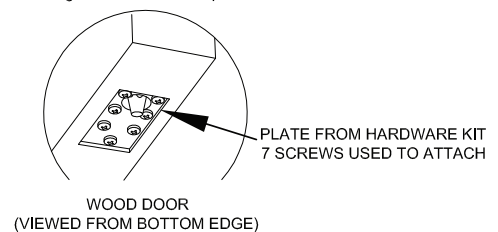

Listings and Approvals -



UL Listed
Panic Hardware



UL Listed Fire Exit Hardware
for 1-1/2 hours, maximum (wood)
8'x10' pairs of doors



Meets ADA requirements



ULC 97, Standard 7-2 and
UL10C for positive pressure



ANSI/BHMA certified A156.3



Meets NFPA 80 & 101
for Life Safety

Detex Limited Warranty -

10 Year Mechanical/3 year Electrical
Limited Manufacturer's Warranty

Where Trust is Built™
DETEx®
Life Safety and Security Door Hardware

Detex Corporation
302 Detex Drive
New Braunfels, Texas 78130-3045 USA
PH. (830) 629-2900
(800) 729-3839
FAX (830) 620-6711
(800) 653-3839
<http://www.detex.com>
USA Sales:
marketing@detex.com
International Sales:
export@detex.com