

VALUE SERIES®

V40 x W

Weatherized Rim Exit Device

The V40 Series **rim exit device** is secure and durable **panic and fire exit hardware** at an economical price. It is designed for use on all types of single and double doors and gates with mullions that are or may be exposed to the weather. The patented mounting plate and strike locator system ensures the easiest and most accurate installation of panic hardware available. In addition to listing as UL panic and fire exit hardware device, this device conforms to UL1034-33 Temperature Section 33, UL1034-53 Dust Section 53, MIL-STD 810F, Method 506.4 (driving rain test); MIL-STD 810F, Method 509.4 (salt fog test) and UBC standard 7-2 (positive pressure).



Standard V40 Rim Device accommodates wide stile doors, 3" or greater stile, and flush doors. For Narrow Stile doors, 2" to 2 1/2" stiles, specify V40 NS model which provides a 2" longer device and a lower profile strike.

Benefits -

- Priced to be the best value for durable and attractive loss prevention panic hardware
- Fast and easy installation
- Minimal door prep saves time and money
- Fits almost any door in any décor
- Outside trims are easily changed or rekeyed without removing device from door

Features -

- Patented mounting plate and strike locator
- Covers a 161 door prep
- Stainless steel, 3/4" deadlocking Pullman-type latch bolt
- Non-handed
- Field sizeable
- 1/8 turn hex key dogging
- Heavy-duty angled end cap
- Heavy-duty ribbed aluminum rail extrusion
- High impact ABS and anodized surfaces
- Withstands over 1400 pounds of static pull force for greater security
- Modular design accepts a variety of outside trims and functions
- Standard and narrow stile pull trims available

Mechanical Options -

- CD - Cylinder Dogging
- HD - Hex Dogging (Std.)
- LD - Less Dogging
- 36 - Fits 36" Door Width (Std.)
- 48 - Fits 48" Door Width
- F - 3 Hour Fire Rated
- H - Hurricane Rated
- NS - Narrow stile door option
- 99 - Surface Strike (Std.)
- 98 - Semi Mortise Strike
- Available with 628 Base Rail Extrusion (Std.)
- Available with 711 Base Rail Extrusion

Electrical Options -

- Weatherized Exit Alarm (EBxW)
- Weatherized Request to Exit High Voltage (EXVxW)
- Weatherized Request to Exit (EXxW)

Refer to Electrified Options section for more information

Where Trust is Built™
DETEx®
Life Safety and Security Door Hardware

Accessories -

- SN1 - Sex Nut Fasteners
- GB2 - Glass Bead Kit

- NSK- Narrow Kit - for 2" narrow stile glass door applications that must be added in the field
- GTPLV40 - Adjustable Gate Plate

- Outside Trim (see Value Series Trim Options)
- Optional Sex Nuts or Security Torx Screws available

Technical Information -

- Door Types - Wood, Hollow Metal, Fiberglass or Aluminum
- Door Thickness - Fits standard 1-3/4" - 2-1/4"
- Door Stile - Fits 2-1/2" stile doors with 99 surface strike (Std.)
- Door Stile - Fits 2" narrow stile doors - specify NS

- Machine and Self-Drilling Screws (Std.)
- Recommended Plate Size
Gate - 1/8" thick plate, galvanized, or painted steel or 1/4" thick aluminum plate, minimum Height - 10"

Strike - 1/8" thick plated, galvanized, painted steel plate, angle iron, or 1/4" thick aluminum plate, minimum Height - 5"

Stop - 1/8" thick plated, galvanized, or painted angle iron or 1/4" thick aluminum angle plate, minimum Height - 2"

Dimensions -

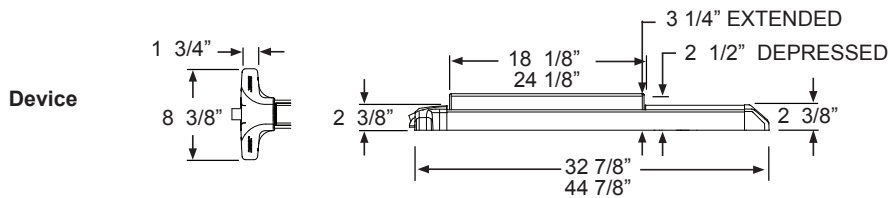

18 1/8" & 32 7/8" device dimensions for 36" door
24 1/8" & 44 7/8" device dimensions for 48" door
Add 2" for NS

Single Gate Riser

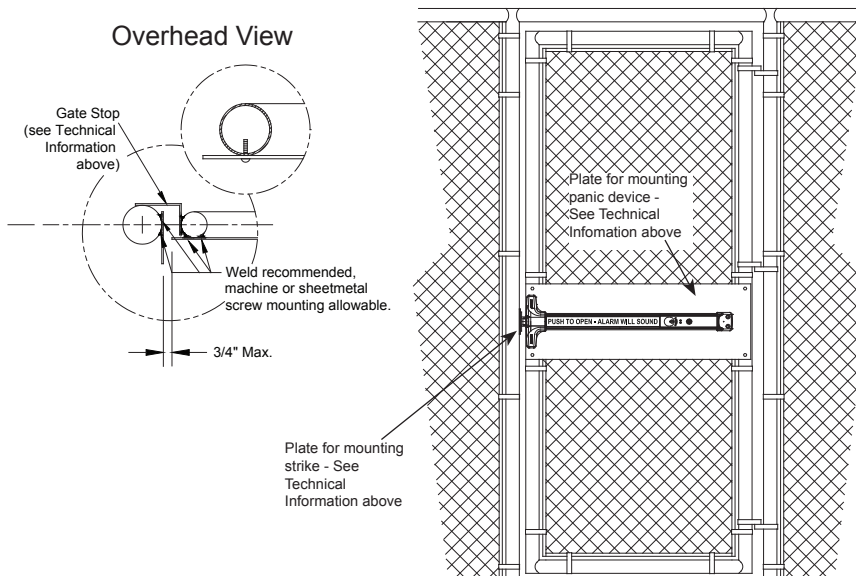

Detex Limited Warranty -

10 Year Mechanical/3 Year Electrical
Limited Manufacturer's Warranty

Listings and Approvals -

- UL Listed
Panic Hardware
- UL Listed Fire Exit Hardware
for 3 hours, maximum
4'x10' single doors and pairs of
4'x8' with F90KR key removable Mullion
- UL1034 - 33 Temperature Section 33
[Temperature Range -31° F (-35° C) to
150° F (+66° C)]
- UL1034 - 53 Dust Section 53
- Meets ADA requirements
- UBC 97, Standard 7-2 and
UL10C for positive pressure

- BHMA
ANSI/BHMA certified A156.3
- NFPA
Meets NFPA 80 & 101
for Life Safety
- MIAMI-DADE
NOA 10-0303.02 EXP. 04/07/15
State of Florida Approval FL9052
- California State Fire Marshall -
4140-0127:105 & 3725-0127:108
- MIL-STD 810F (G), Method 509.4
(Salt Fog Test)
- MIL-STD 810F (G), Method 506.4
(Driving Rain), Procedure 1

Where Trust is Built™
DETEX®
Life Safety and Security Door Hardware

Detex Corporation
302 Detex Drive
New Braunfels, Texas 78130-3045 USA
PH. (830) 629-2900
(800) 729-3839
FAX (830) 620-6711
(800) 653-3839
<http://www.detex.com>
USA Sales:
marketing@detex.com
International Sales:
export@detex.com