



## 82 SERIES

## 83 SERIES (Top Rod Only)

### Concealed Vertical Rod Device - Wide Stile Aluminum Door

Designed to enhance the architectural aesthetics of any décor, the 82 and 83 Series **concealed vertical rod exit device** is also super-heavy-duty **panic and fire exit hardware** for use on all types of wide stile aluminum doors without a mullion. The patented mounting plate system ensures the easiest and most accurate installation of panic hardware available.

Note: For Top Rod Only - Specify 83 Series

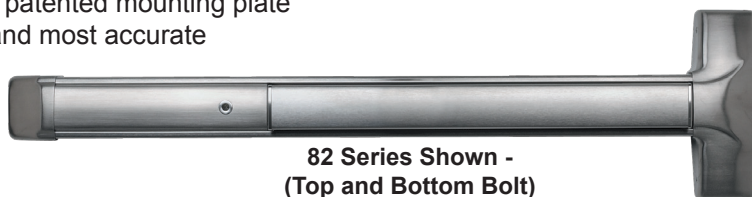

82 Series Shown - (Top and Bottom Bolt)

ANSI 156.3 - 2008  
Grade 1  
Type 8

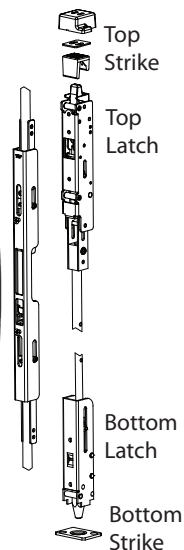

#### Benefits -

- Tough and durable design for years of trouble-free service in high-use, high-abuse environments
- Minimal door prep saves time and money
- Aesthetically pleasing options to meet various applications including:  
60/61 CVR Narrow Stile Alum. Door  
62/63 CVR Narrow Stile H.M. Door  
70/71 CVR Wide Stile Wood Door  
80/81 CVR Wide Stile H.M. Door  
82/83 CVR Wide Stile Alum. Door
- Fast and accurate installation
- Except for 03WSV, outside trims are easily changed or rekeyed without removing device from door

#### Features -

- 6-position multi-step action in top latch keeps top and bottom bolts retracted until door closes and provides more consistent re-latching and security to door
- Top strike fully adjustable both vertically and to accommodate a variety of varying weather strip thicknesses
- Top strike both secures the door and re-engages the latchbolts
- Patented deadlocking of top (82 and 83 Series) and bottom bolt (82 Series) assemblies
- Durable steel bottom drop bolt (82 Series)
- Rods are easily adjustable with rods installed in door
- Angled end-cap deflects damage away from device
- Handed - field reversible
- Field sizeable
- 1/8 turn dogging

#### Mechanical Options -

- F - 3 Hour without astragal up to 10 foot (steel) door
- HD - Hex Dogging (Std.)
- CD - Cylinder Dogging
- SLR - Silencer
- 30 - Fits 30" Door Width - limited electrical options
- 36 - Fits 36" Door Widths (Std.)
- 48 - Fits 48" Door Widths
- EC1 - Ramped Endcap - Heavy duty (standard on 630, 606, 612, 613, 605, 611 & 629 finishes only)
- EC2 - Flush Endcap (standard on 628, 693 & 695 Finishes only)

#### Electrical Options -

- Exit Alarm (EA)
- Electric Dogging (ED)
- Electric Latch Retraction (ER)
- Delayed Egress Self-Contained (EE)
- Request to Exit (EX)
- Request to Exit for High Voltage (EXV)
- Electric Delayed Egress x Latch Retraction (EEExER)

Refer to Electrified Options section for more information



**Accessories -**

- SSK4- Security Torx Screw Kit
- Trim Functions (see Outside Trims)
- Electrified Options (see Electrified Options)

**Technical Information -**

- Door Types - Aluminum/ Aluminum Channel FRP
- Door Thickness - Fits standard 1-3/4" - 2-1/4" (for other door thicknesses contact factory)
- Door Stile - Fits minimum 4-1/2"
- Fasteners - Machine and Self-Drilling Screws standard
- Rail is heavy ribbed aluminum extrusion

**Finishes -**

605 / US3 Polished Brass	628 / US28 Satin Aluminum	693 / SPBLK Black, painted
606 / US4 Brushed Brass	629 / US32 Polished Stainless Steel	695 / SP313 Dark Bronze, painted
611 / US9 Polished Bronze	630 / US32D Brushed Stainless Steel	
612 / US10 Brushed Bronze		
613 / US10B Oil Rubbed Bronze		

**Top & Bottom Latch Door Prep for 82 & 83 Series**

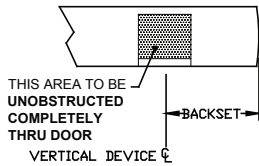
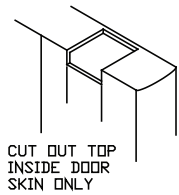

LATCH MOUNTING TOP & BOTTOM

**Top Latch Installation for 82 & 83 Series**

Release to extend bolt

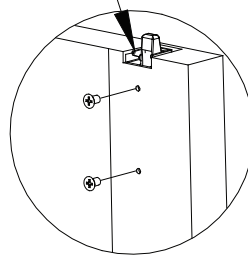

**Top Strike Installation for 82 & 83 Series**

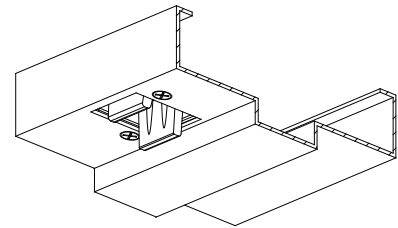

**Detex Limited Warranty -**

10 Year Mechanical/3 year Electrical Limited Manufacturer's Warranty

**Bottom Latch Installation for 82 Series Only**

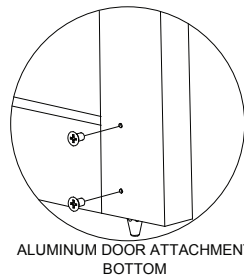

**Listings and Approvals -**



UL Listed  
Panic Hardware



UL Listed Fire Exit Hardware  
UL 10 B/C  
8'x10' pairs of doors



Meets ADA requirements



UBC 97, Standard 7-2 and  
UL10C for positive pressure



ANSI/BHMA certified A156.3



Meets NFPA 80 & 101  
for Life Safety



Detex Corporation  
302 Detex Drive  
New Braunfels, Texas 78130-3045 USA  
PH. (830) 629-2900  
(800) 729-3839  
FAX (830) 620-6711  
(800) 653-3839  
<http://www.detex.com>  
USA Sales:  
marketing@detex.com  
International Sales:  
export@detex.com